



# ARNING<sup>TM</sup>

C O M P A N I E S

**ONE COMPANY<sup>TM</sup>**  
**ONE SOLUTION**



## OVER 40 YEARS OF INNOVATION

### **ARNING COMPANIES**

201 Industrial Park Place,  
Cassville, MO 65625  
800-732-5074  
[www.arningco.com](http://www.arningco.com)



# ABOUT ARNING COMPANIES



## FULL SERVICE CONSTRUCTION COMPANY

We use the latest innovative processes and practices to solve our customer's construction needs quickly and efficiently.

## SPECIALIZING IN MODULAR CONSTRUCTION

Using modular construction, panelized wall systems or kiosks, we deliver your completed project with less wasted time, resources and money.

## WE OFFER THE COMPLETE SOLUTION

From the building, awnings, sidewalk covering, stand alone service buildings and architectural building elements, we handle it all.

## FULL SERVICE UNDER ONE ROOF

We have architects, engineers, construction managers and installers, all under one roof to insure that no detail is lost in translation.

## FAST, ON-SITE ERECTION

We have installation crews that are stationed across the country. No more delays due to lack of available skilled labor.

## CONSISTENT PRODUCT

Since we manufacture most of the pieces in our central location, you can depend on a consistent product, wherever your project is erected.



# ONE COMPANY ONE SOLUTION

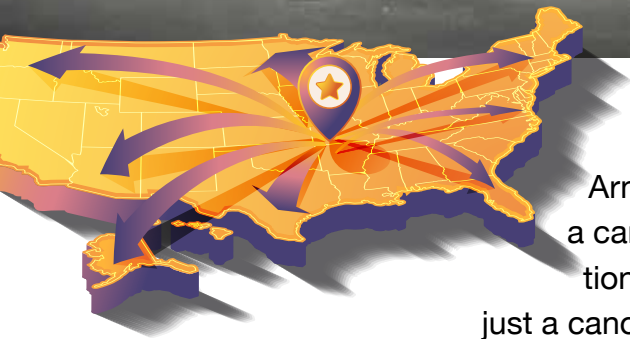

Arning Companies started in 1983 with a handful of employees, as a canopy company. Through the decades, hard work and dedication has brought the company to a new era of manufacturing. Not just a canopy company, Arning has grown to be a national leader and a game-changer in the Industrialized Construction Industry.

## IF YOU CAN DREAM IT, WE CAN BUILD IT.

We believe that by consolidating the architectural design, manufacturing, and construction management processes into one company, we can offer a single-source solution that makes a significant impact on the construction industry. We are determined to revolutionize the way architecture, engineering, and construction work together so our partners can reap the benefits of having less waste and faster results - all at a more competitive price than traditional methods.





# MANUFACTURED PRODUCTS

## ENTRANCE CANOPIES

An entrance canopy from Arning offers weather protection to your building entrance and visitors, as well as adding an architectural uplift to even the most humble of buildings. Arning canopies are custom tailored to suit any application, and are designed to create a welcoming, defined entrance as well as give your customers a great first impression of your business.



## WALKWAY COVERS

Enhance your building's architecture and the curb appeal of your business with an attractive walkway cover from Arning Companies. Well-engineered and well-built, our walkway covers will hold up to the elements, providing comforting shelter to customers and pedestrians in both private and public facilities.





# MODULAR BUILDING CONSTRUCTION

## PERMANENT / RELOCATABLE

Standardizing a design and having the same group of workers build these facilities allows for significant economies of scale, making it a more effective model for both buyer and manufacturer.

- **Economies of Scale**

Modular provides a customizable layout, design and functionality that can be standardized for other locations, allowing you to provide the most efficient service at every business location.

- **Modular in Design**

Constructing off site using a modular design allows for an easier process for obtaining the correct building permits.

- **Easier Permitting**

Using this strategy, multiple units can be built simultaneously, expediting the rate of growth and expansion for any chain or franchise.



## MODULAR BENEFITS

Modular construction makes it possible for your next building to be constructed in a controlled environment, then shipped directly to the job site.

- Less material waste
- Reduced construction schedule
- Elimination of delays due to weather
- Operational 30-50% sooner than conventional construction
- Improved air quality
- Reduce field labor costs
- Safer construction overall
- Limitless design possibilities



# PANELIZED WALL SYSTEMS

## CONDENSED CONSTRUCTION SCHEDULE

Wall panel fabrication can start as soon as the permit is issued. No weather delays, or labor issues to hinder construction.

## CUSTOMIZABLE TO SUITE YOUR NEEDS

Can be customized for any commercial application. Our Built-to-order wall sections are engineered to eliminate costly mistakes and waste.

## MATERIAL OPTIONS

Choose between wood or steel options for the best fit for your needs.

## MULTIPLE FINISH OPTIONS

Many finish and color options to choose from to match your signature look. All styles and finishes will be consistent across all of your projects, no matter what part of the country we erect your building.

## FAST, ON-SITE ERECTION

Direct to job-site delivery once the foundation cures means quicker timelines and fewer complications. Spend less time building and more time profiting from your new location.

## CONSISTENT PRODUCT

Give us your plans or get design help directly from our experienced technical team. Our years of experience in the industry means we can head off many of the pitfalls that come from any new construction.

## STANDARDIZATION

Controlled manufacturing environment and horizontal material application resulting in a tighter, high quality finished wall ready for erection. Once installed, walls are ready for rough in and inspections.

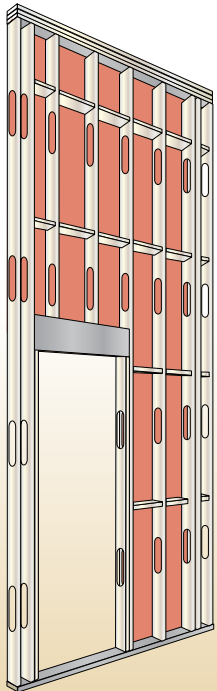
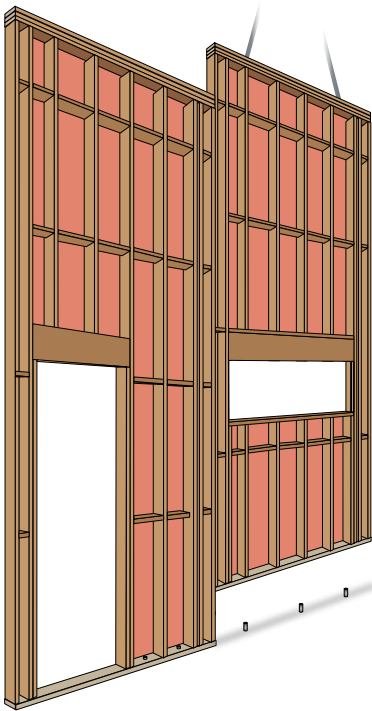



# CONSTRUCTION MANAGEMENT

## FULL SERVICE PARTNER

If you're like most owners, you're aware of the redundancy in a traditional construction project. You spend valuable time calling the architect, the engineer, the manufacturer, the general contractor and the subcontractors.



## ARNING IS DIFFERENT

With Arning by your side, you'll get the architect, engineer, manufacturer, and contractor all in one. By consolidating each of these roles into a centralized hub, we eliminate waste and lost time throughout the 90–120-day construction cycle.





# ARNING

C O M P A N I E S



# ONE COMPANY ONE SOLUTION

201 Industrial Park Place  
Cassville, MO 65625  
**800-732-5074**  
[www.arningco.com](http://www.arningco.com)